

The logo for Air³, featuring the word "air" in a lowercase, sans-serif font, followed by a superscripted "3".

air³

A photograph of an Air³ room interior, showing a white ceiling with integrated lighting and ventilation, and a dark grey wall. The image is partially overlaid with a light blue semi-transparent rectangle.

Integrated Services electrical systems/power

Air³ rooms provide a controllable micro-environment.

All Air³ Pods have an integrated electrical services solution powered by a main connection to the building, once the pod is assembled.

The logo for orangebox, featuring the word "orangebox" in a lowercase, sans-serif font.

orangebox

Power

Air³ contains electrical services, including power, lighting and airflow.

These services share a single circuit and utilize a 15 amp connection.

- Each Service Hoop is provided with a 9' flexible power cord which is to be plugged directly into a building's hardwired electrical receptacle. The standard cord will provide a max visible length of 7 - 8' when existing the Service Hoop cable grommet. When placed against a wall, a minimum spacing of 4" between the receptacle and the assembled unit is needed to protect the plug from damage.
- If a hardwired connection is needed, see page 3. Hardwire conduit must be provided and connected by a certified electrician.

Power usage when occupied is 100W (not including any plugged-in external equipment) per hoop and less than 1W when unoccupied.

- Max. Voltage: 120 VAC
- Max. Current: 15 AMPS (1440W)

Hoops & Outlets

Air-23/25 — Single Service Hoop

1 connection point per service hoop

Integrated power for:

- LED lighting
- Air fan
- User control panel
- Opening roof
- 3 x Power sockets

Air-27/29 — Double Service Hoop

1 connection point per service hoop

Integrated power for:

- LED lighting
- Air fan
- User control panel
- Opening roof
- 6 x Power sockets

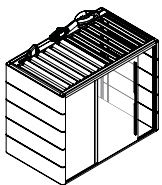

Air-23

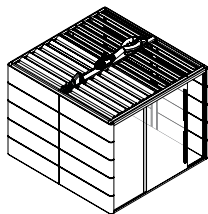

Air-25

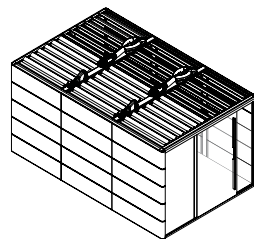

Air-27

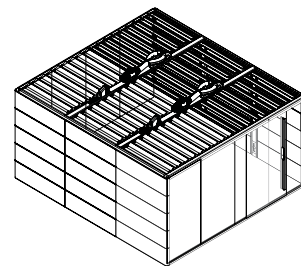

Air-29

Connection Routing

Service hoop upright: hinged door access to interior for cabling should be handled by installation teams ONLY.

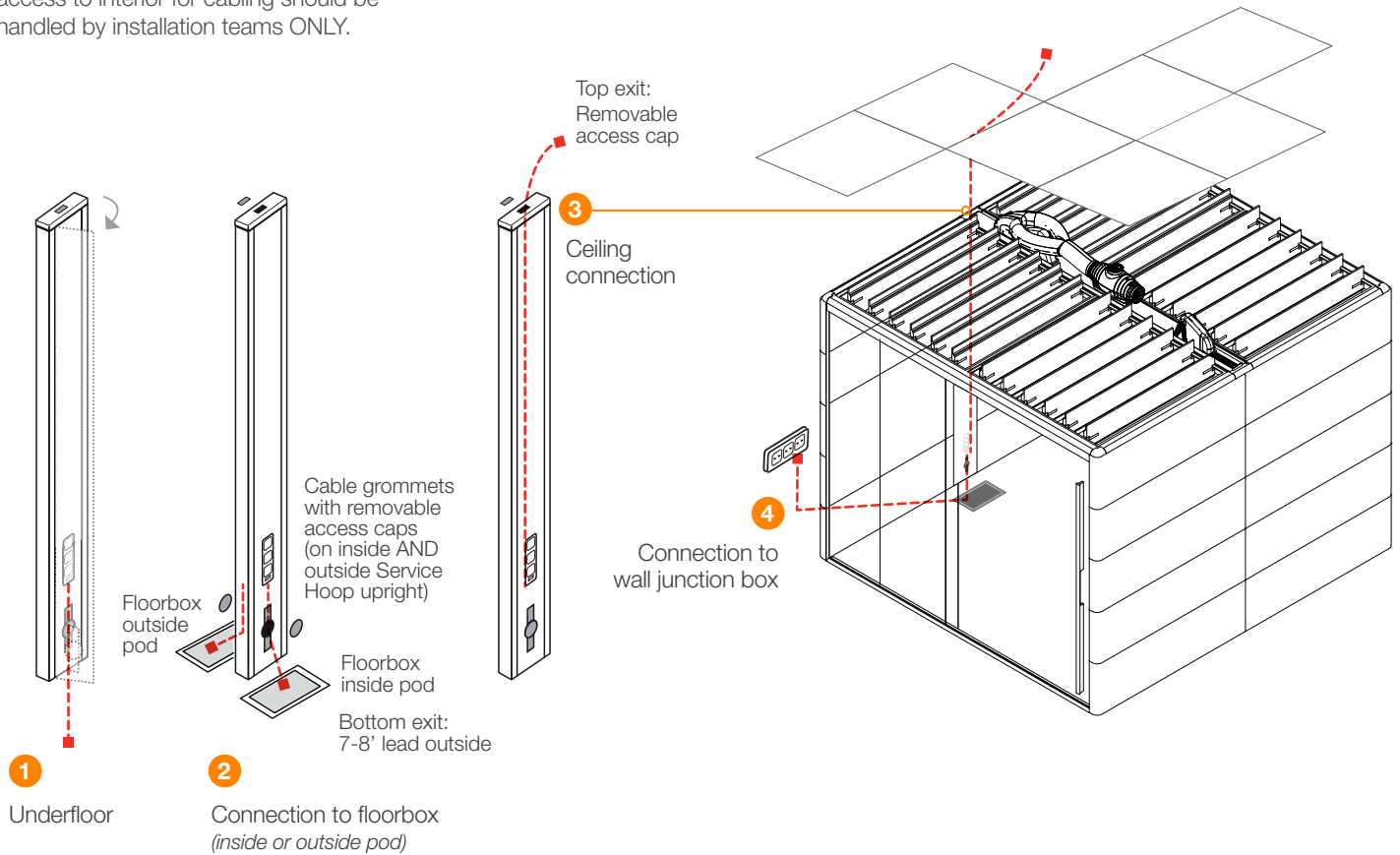

Routing Options

- 1. Underfloor:** 9' cord from pod power box down through raised floor.
- 2. Floorbox:** 9' cord routed through cable grommet to floor box inside or outside of pod.
- 3. Ceiling:** The provided 9' cord will not reach the ceiling. A certified electrician must provide and connect the power source from the pod power box to the building, i.e. a flexible hardwire conduit or cord with 3 prong plug. Each Service Hoop power box would require a separate 15-amp connection. **DO NOT** daisy chain the Service Hoops together.
- 4. Wall:** 9' cord routed through cable grommet to wall power outlet.

Hardwire Power Connection

Permanent Connection to Building and Hard Wiring Point

For permanent connection each service hoop requires a single 15 amp connection. This must be connected into the hoop. The operating usage for each service hoop is 100 watts. There are three receptacles on the bottom side of hoop – the opposite side to the control panel. The maximum loading of the hoop is 1.8 kilowatts. Two data ports can also be integrated into the hoop – located at the bottom of the hoop below the receptacles. Orangebox does not provide these wires.

This product must be connected to a grounded metal, permanent wiring system, or an equipment-grounding conductor must be run with the circuit conductors and connected to the equipment-grounding terminal or lead on the product.

A suitable cable restraint must be fitted to the supplied standard 1/2" trade size conduit fitting.

There are several types of conduits and cables that could be used in accordance with Chapter 3 of the NEC.

Customers who require alternative connection to the listing for a specific project work directly with the AHJ and local code consultant.

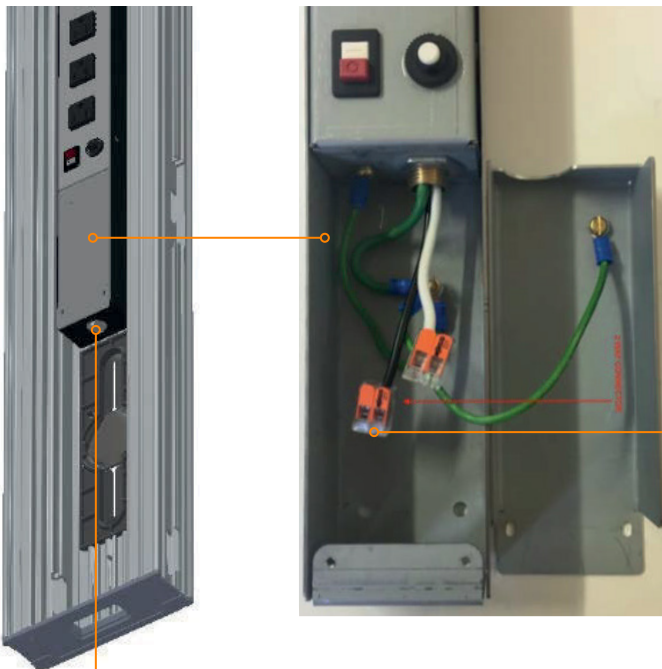

Power connection to be made through this hole. Can either be a solid or flexible conduit. See next page.

This is a two-way connector. The hardwired connection will be made here. Each hoop requires a single 15 amp connection.

Hoop to Hoop RJ45 Connection

Air27 & Air29 Specific

A simple 3.5m RJ45 comms cable connects hoops together between each AMS to allow all lights and fans to operate at the same time from one user panel. No Need to pair them up at the factory.

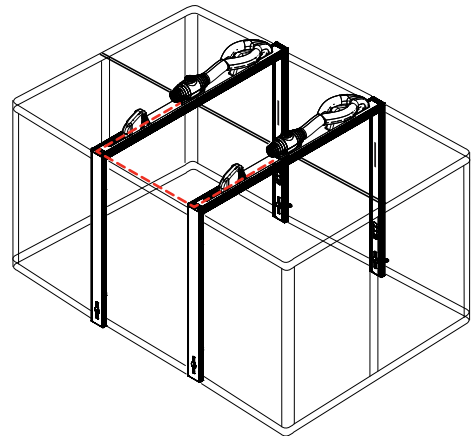

Internal Panel & Port

The interior control panel allows the user to set the lighting and airflow, as well as adjust the roof.

The power solution is seamlessly integrated within the service hoop and feeds the power required for the lighting and airflow system.

3 Power Sockets are supplied as standard for user-power.

Electric Control Panel

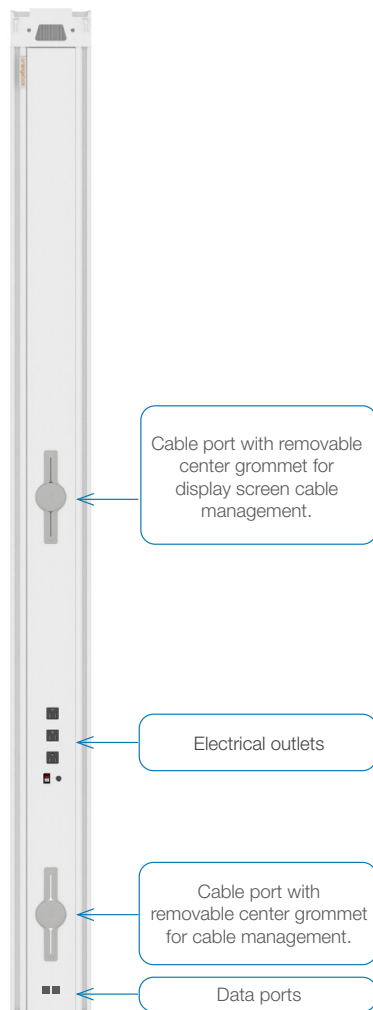

User Control Panel

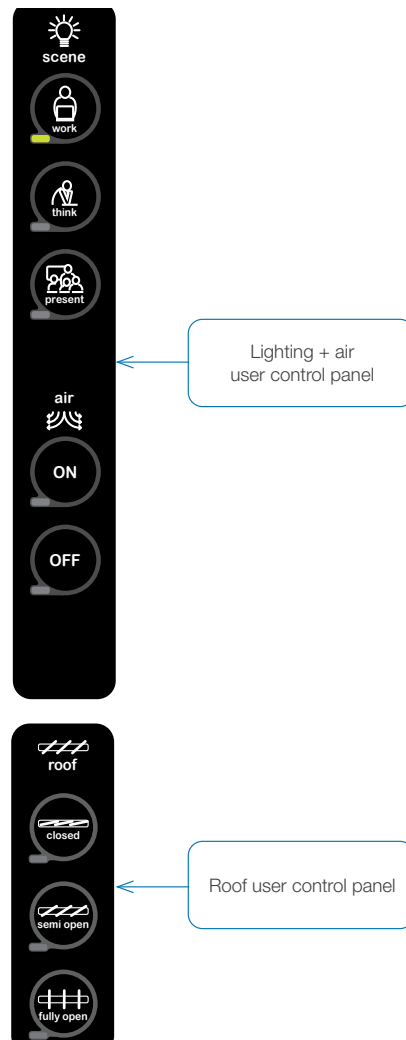

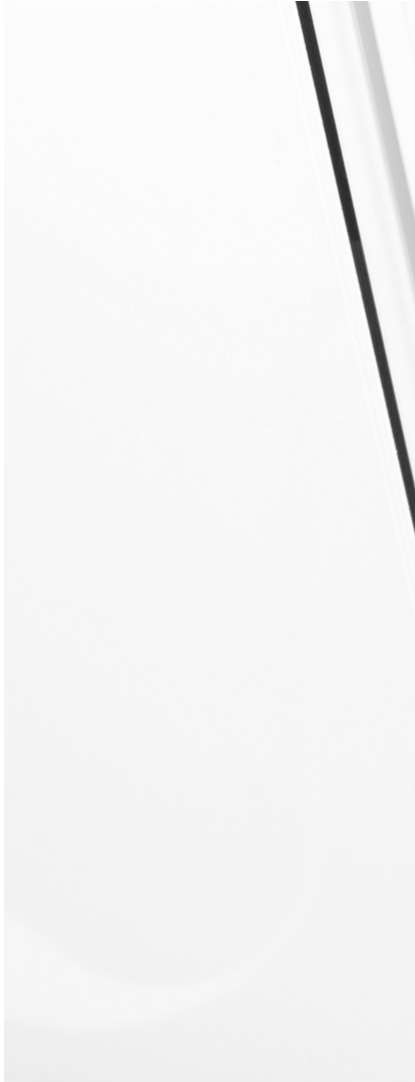

orangebox

Contact

us.support@orangebox.com

SMR #23-000000980T 10/2023 ©2023 Orangebox. All rights reserved. All specifications subject to change without notice. Trademarks used herein are the property of Orangebox or their respective owners.

steelcase.com/brands/orangebox